

# Multilink® Automix

## Placement of glass ceramic restorations (Inlays, onlays, crowns, bridges, posts)

### Restoration

**Pre-treatment of ceramic restorations:**  
According to manufacturer's instructions.  
E.g. IPS Empress: Etch for 60 s  
IPS e.max CAD/Press: Etch for 20 s  
with IPS Ceramic etching gel (hydrofluoric acid).  
Follow safety instructions.

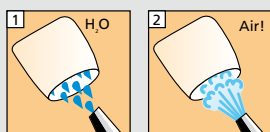

Monobond Plus

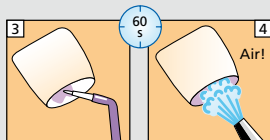

### Dentin/Enamel

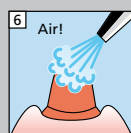
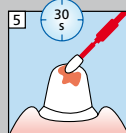
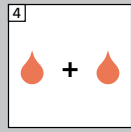

scrub 30 s

Multilink Automix

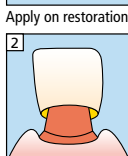
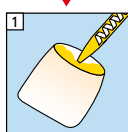

Secure the restoration

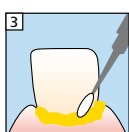

Remove excess immediately

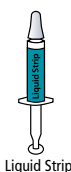
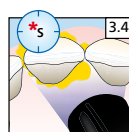
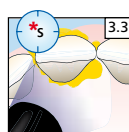
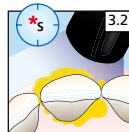
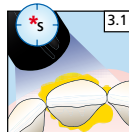

Liquid Strip

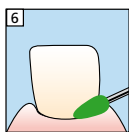
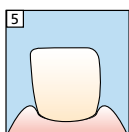

* Light intensity	Exposure time per quarter segment	
Indicated for cases with up to 2 bridge abutments = 3 to 4-unit bridges		
approx. 650 mW/cm <sup>2</sup>	3 s	e.g. Bluephase in LOW POWER mode
approx. 1.000 mW/cm <sup>2</sup>	1-2 s	e.g. Bluephase Style or Bluephase in HIGH POWER mode
Indicated for cases with up to 6 bridge abutments = circular bridges		
approx. 650 mW/cm <sup>2</sup>	1 s	e.g. Bluephase in LOW POWER mode

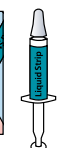
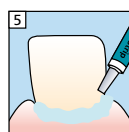
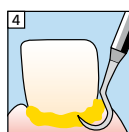

Liquid Strip

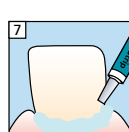
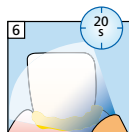

e.g. Bluephase Style

CE 0123



more information  
[www.cementation-navigation.com](http://www.cementation-navigation.com)



see  
Instructions

ivoclar  
vivadent  
clinical

649902/2013-06-04/Rev. 1